

# Robertson Thermal System (RTS)



Quality Products, Quality Service



Every effort is made to ensure the accuracy of information at the time of publication. In accordance with ongoing efforts to improve our products and performance, Robertson Building Systems reserves the right to change information without notice. For the most current information, visit [RobertsonBuildings.com](http://RobertsonBuildings.com)



Corporate Office | 1343 Sandhill Dr., Ancaster, ON L9G 4V5  
| 800-387-5335, 905-304-1111, f 905-304-2420

Western Office | 11318-163 St. NW, Edmonton, AB T5M 1Y6  
| 780-485-3055, f 780-461-7785

[RobertsonBuildings.com](http://RobertsonBuildings.com)  
ROB-RTS-0415





# Add more R-value to your existing building quickly and easily with RTS



**The Robertson Thermal System (RTS) is one of the industry's most proven roof and wall systems with millions of square feet installed.**

The Robertson Thermal System (RTS) provides energy efficiency and a finished interior appearance. Accommodating up to 12" of uncompressed insulation, RTS provides an effective thermal barrier for energy efficient roof and wall construction.

RTS consists of an exterior panel and a liner panel, separated by thermal spacers. Various thicknesses of metal building insulation can be accommodated between the two panels with minimum through-metal contact.

RTS reduces heat loss through the envelope compared to traditional metal building insulation systems so that smaller heating/cooling units that consume less energy may be used, reducing initial and building operating costs. RTS helps control condensation through vapor retardation. The interior liner panel supports and protects insulation while providing an attractive, easy-to-clean interior finish.

Intended for both new and retrofit construction, cost-effective RTS is easily customized to provide the level of energy efficiency required for your building.

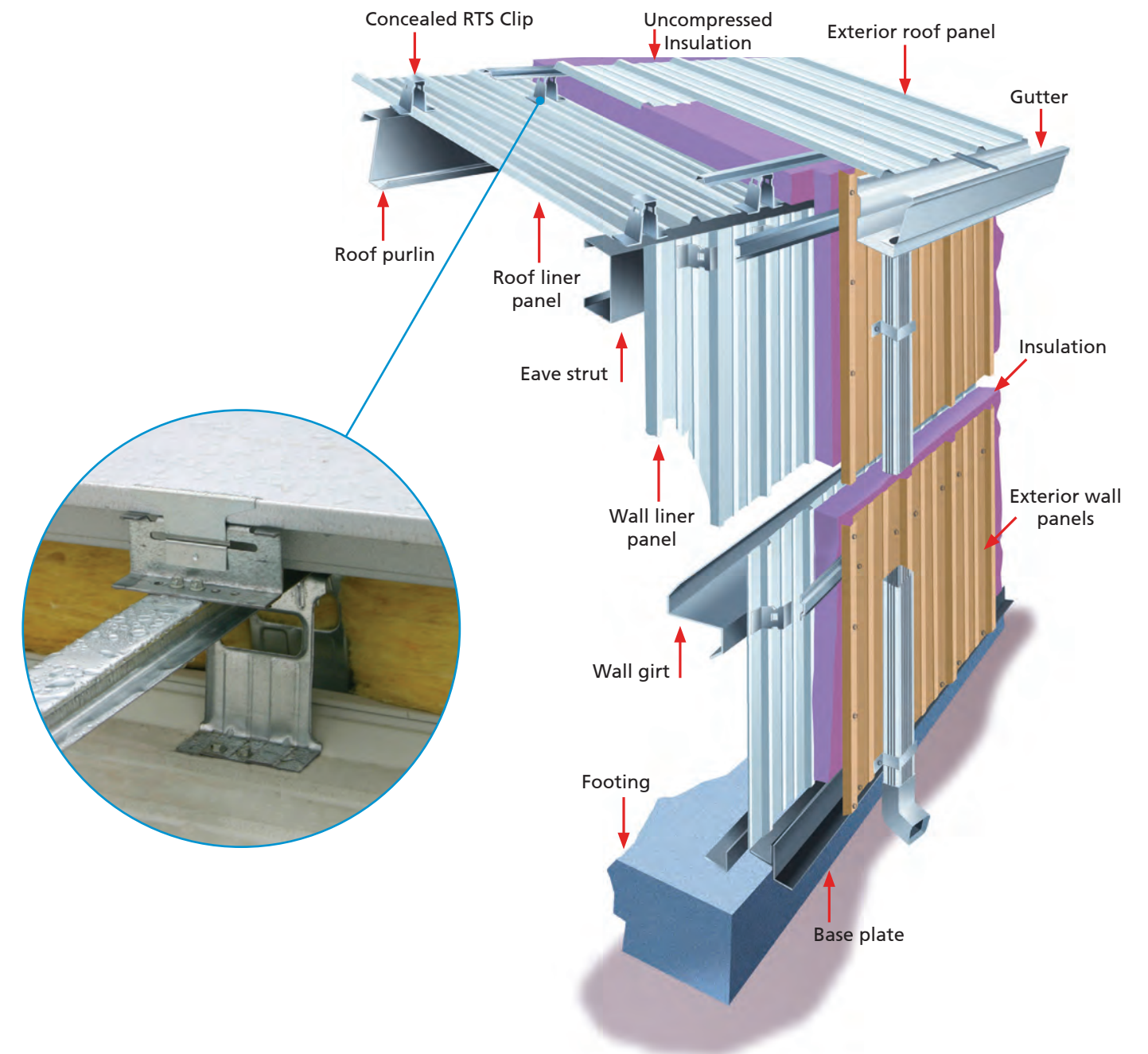
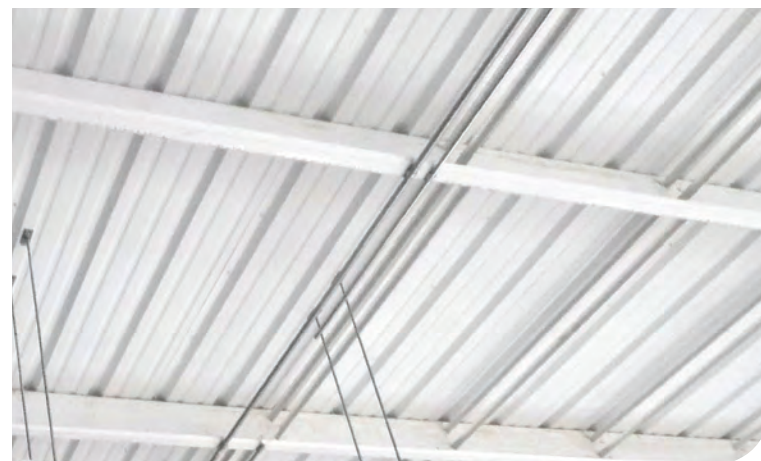
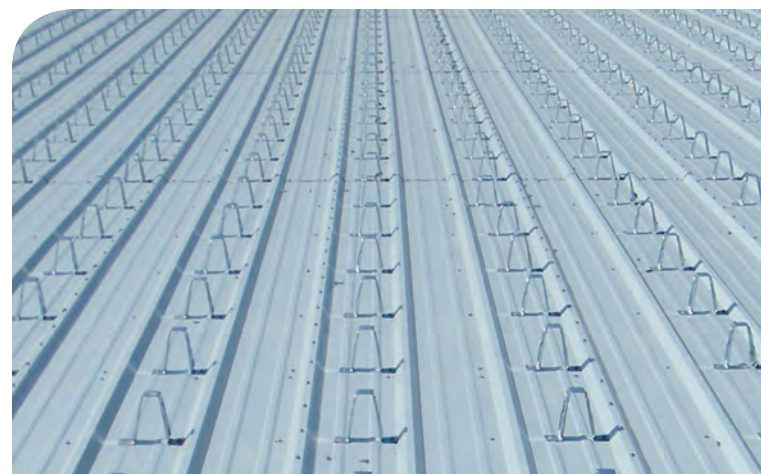

## Advantages of Robertson Thermal System (RTS)

- ✓ RTS can be used for both new and retrofit construction
- ✓ Accommodates up to R-43 (R-13 + R-30) fiberglass insulation and has a tested U-factor of 0.0321 BTU/hr-ft<sup>2</sup>-F (0.1825 W/m<sup>2</sup>-K)
- ✓ Standing seam and through-fastened panel roof systems available
- ✓ Concealed fastener and exposed fastener wall systems available
- ✓ Well-insulated buildings consume less energy, resulting in lower operating costs
- ✓ Insulation can help reduce noise transmission
- ✓ RTS clip designed for minimal through-metal contact
- ✓ RTS clips in 4, 6, 8, 10 and 12" heights allow selection of desired energy efficiency levels
- ✓ Simple construction details enable fast installation
- ✓ Interior liner attached to the top of purlins acts as a working platform for ease of installation
- ✓ Liner panel on inside of building protects insulation and provides an attractive, durable, clean interior
- ✓ Steel liner panel acts as a diaphragm to reduce the need for structural bracing, reducing cost
- ✓ No shut-down required during re-roof